

LIVFAST SOLAR

GRID INTERACTIVE INVERTERS

BETTER HAITOH HAI



ABOUT **LIVFAST**

About Livfast: Livfast is the leading power specialist in India with a widespread portfolio of Power back up solutions such as Automotive Batteries, Inverters, Inverter Batteries, Solar Applications. We listen and understand the needs of the consumers and answer these needs in form of our products. We, at Livfast strive to be constantly innovating to make lives across the country easier for our consumers.



GRID INTERACTIVE INVERTER (GI)

PRODUCT DESCRIPTION

Livfast Grid Interactive Inverter is a state of the art technology that converts DC power from solar to AC power with the inherent ability to synchronize with the utility grid. Its interface with net metering allows it to sell excess solar power back to the grid.

APPLICATION

Homes and establishments that need to reduce their electricity bills.



Wide operating voltage range from 180-276 VAC suitable for Indian grids



8-year warranty to ensure peace of mind and increased ROI



Lowest self-consumption at night (< 1W) leading to greater energy yield



Wide MPPT voltage range and with efficiency > 99.9 % to yield greater solar energy



Best in class intelligent grid interface and management

8 YEAR
PRODUCT
WARRANTY

BETTER HAI TOH HAI



GRID INTERACTIVE INVERTER (GI)

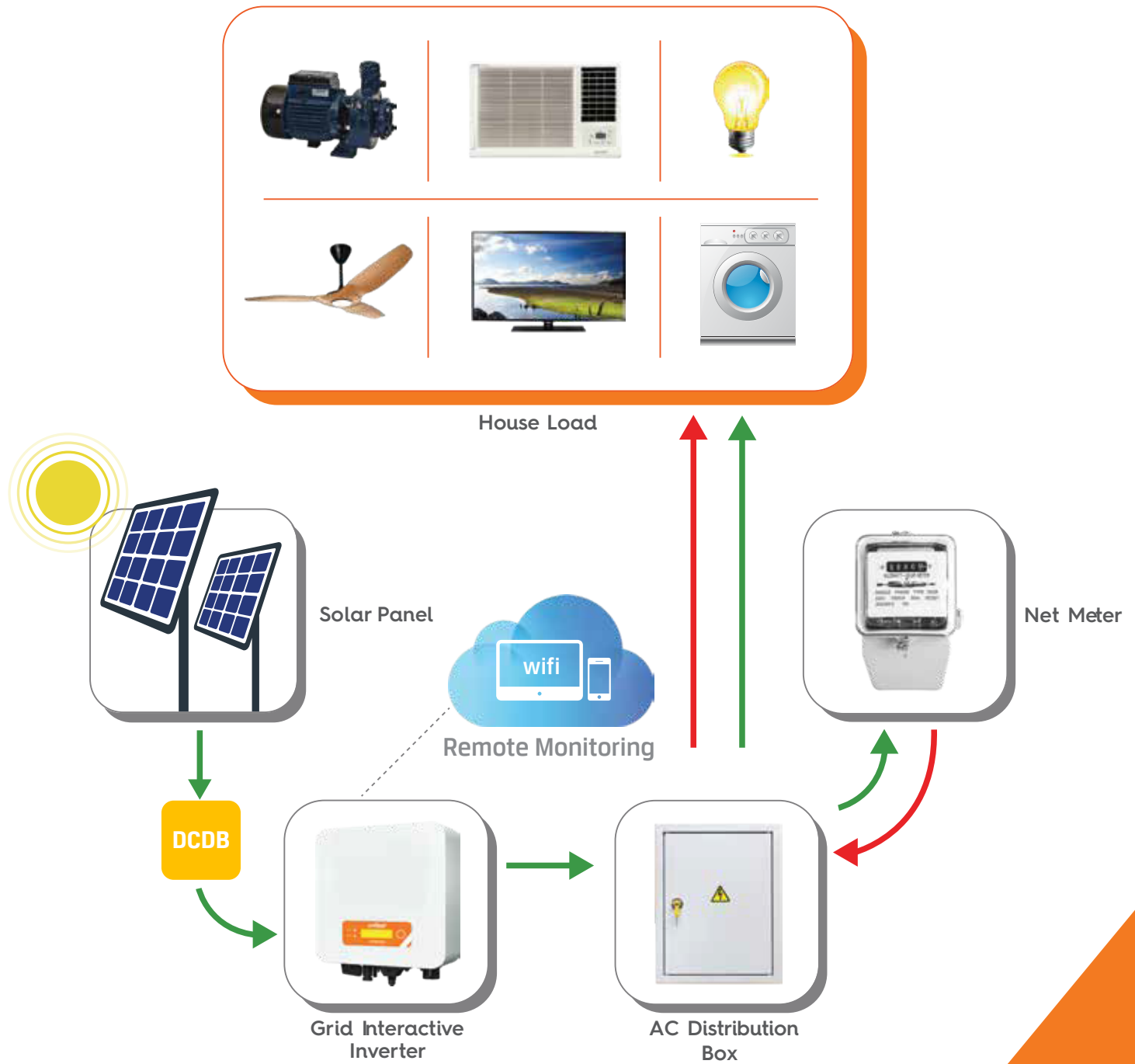

SPECIFICATION

LF Nomenclature	LFS103GIS	LFS105GIS
	Input (DC)	
Recommended Max. PV Input Power	4100Wp	6650Wp
Max. Input Voltage	550V	600V
Number of MPPT/String per MPPT	1/1	2/1
Start-up Input Voltage	70V	120V
Rated Input Voltage	360V	
MPPT Operating Voltage Range	50-550V	90-580V
Full Power MPPT Voltage Range	275-500V	250-520V
Max. Input MPPT current	12Ax1	11Ax2
Max. DC Input Short-circuit Current per MPPT	15Ax1	13.2Ax2
	Output(AC)	
Rated Power	3000W	5000W
Max. AC Power	3000VA	5000VA
Max. Output Current	14.5A	22.8A
Nominal Grid Voltage	L/N/PE, 220VAC 230VAC 240VAC	
Grid Voltage Range	180-276VAC	
Nominal Frequency	50/60 Hz	
Grid Frequency Range	45-55Hz/54-66Hz	
THDi	<3%	
Power Factor	1 Default (+/- 0.8 Adjustable)	
	Efficiency	
MPPT Efficiency	>99.9%	
Self-consumption at Night	< 1W	
Max. Efficiency	97.7%	98.0%
	Protection	
DC Reverse Polarity Protection	Yes	
Safety Protection	Anti-islanding, RCMU, Ground Fault Monitoring	
SPD	MOV: Type III Standard	
	Communication	
Standard Communication Mode	WiFi	
	General Data	
Topology	Transformerless	
Ambient Temperature Range	-30°C to 60°C	-25°C to 60°C
Permissible Relative Humidity Range	0-100%	
Noise	<25dB	
DC Switch	Optional	
Cooling	Natural Convection	
Max. Operating Altitude	2000m	
Dimension	321x260.5x131.5mm	405x315x135mm
Support bracket	Wall-mounted	
Weight	6.3Kg	11.5Kg
Display	LCD+LED	LCD
Degree of Protection	IP65	
Warranty	8 Years	
	Standards Data	
EMC	EN 61000-6-1, EN 61000-6-3, EN 61000-3-2, EN 61000-3-3	EN 61000-6-2, EN 61000-6-3, EN 61000-3-2, EN 61000-3-3, EN 61000-3-11, EN 61000-3-12
Safety standards	IS 16221(Part-2), IS 16169, IEC 62116, IEC 61727, IEC 61683, IEC 60068(1,2,14,30)	IS 16221(Part-2), IS 16169, IEC 62116, IEC 61727, IEC 61683, IEC 60068(1,2,14,30)
Grid standards	EN 50549, UTE_C_15_712-1, VDE V 0126-1-1, UNE 206007-1	VDE V 0126-1-1, V 0124-100, EN 50438, EN 50549, UNE 206007-1 IN

NOTE: Specifications included in this datasheet are subject to change without notice.

GRID INTERACTIVE HYBRID INVERTER (GIH)

PRODUCT DESCRIPTION

Livfast Grid Interactive Hybrid Inverter encompasses the features of Grid Interactive Inverter, including battery backup for essential loads during power failure.

APPLICATION

Homes and establishments that need power backup for emergency loads apart from reduced electricity bills.



Highest Efficiency: 85% with battery system, 95% with solar system



Capable of handling different battery types: Flooded/Gel/Sealed/Li-ion



Best in class overload capacity available: 150% - 30 Sec, 110% - 3 Min



Fan-less design for effective natural cooling



ECO/UPS mode available for maximizing battery backup

60 MONTHS PRODUCT WARRANTY

BETTER HAI TOH HAI



GRID INTERACTIVE HYBRID INVERTER (GIH)

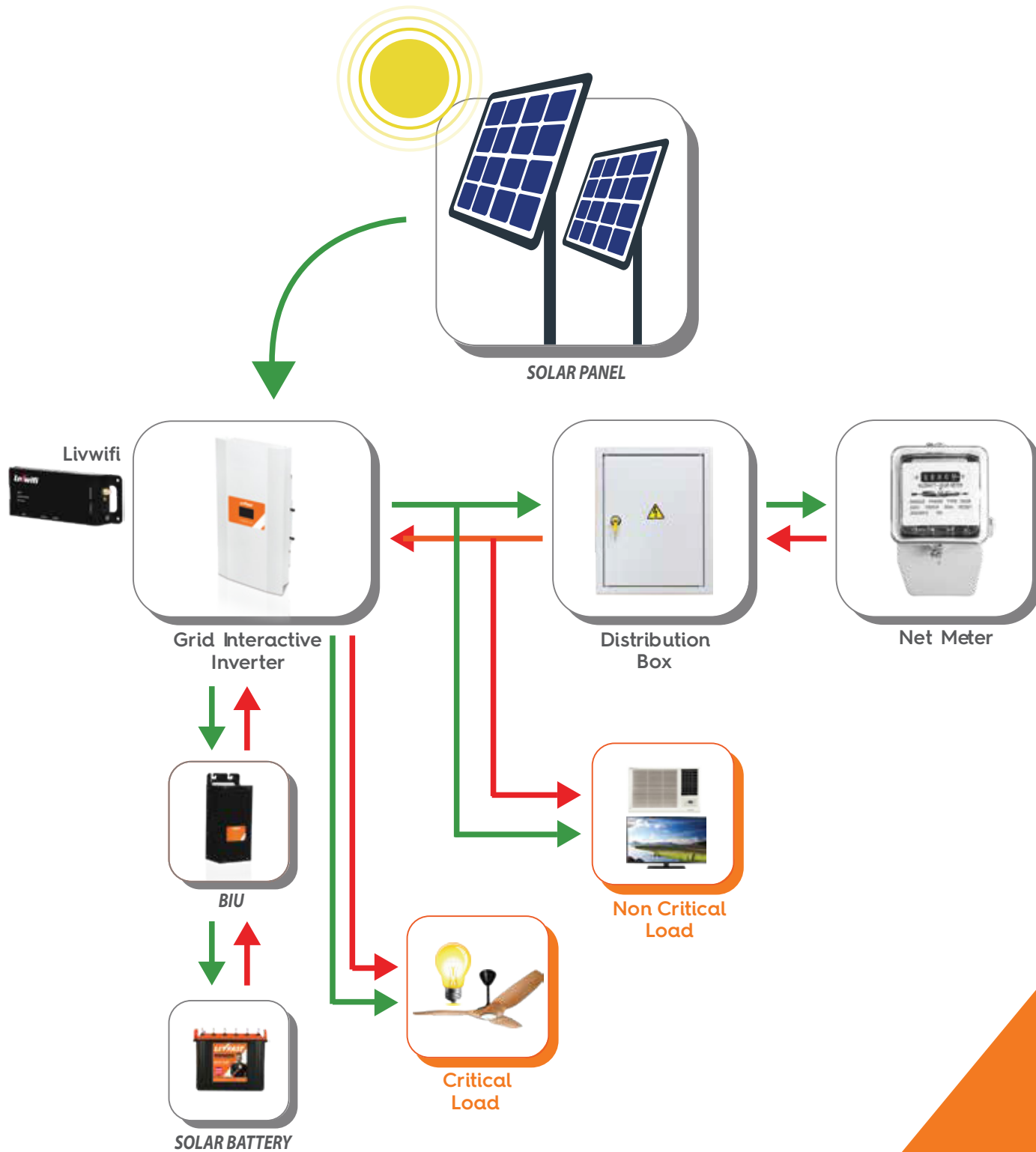

GRID INTERACTIVE HYBRID		
Model No.	LFSI03GIH	LFSI05GIH
Input (DC)		
Max. Recommended PV Power	3600 W	6000 W
Max. DC Voltage	450 V	
Start Voltage	150 V	
Nominal Voltage	260 V	
MPPT Operating Voltage Range	70-380 V	
Max. Input Current	10A	20A
Max. Short Circuit Current	10A	20A
Number of Independent MPPT Trackers/String per MPPT Tracker	1	2
Max. Number of Panels @335Wp per String	10	9
Output (AC)		
Rated AC Output Power	3000 W	5000 W
Max. AC Apparent Power @ Unity PF	3000 VA	5000 VA
Max. Output Current	16 A	25 A
AC Nominal Voltage	180-265 VAC (1 Ph AC Connection)	
AC Grid Frequency	45-55 Hz	
Adjustable Power Factor	+/- 0.8	
Surge Handling Capacity	150% - 30 Seconds; 110 % - 3 Minutes	
THD/THDi	< 3%	
(a) Anti-islanding Time (b) Reconnection Time	(a) < 0.2 Sec (b) < 20 Sec	
AC Grid Connection Type	L+N+PE	
UPS Mode	Regulated/Unregulated	
Efficiency		
Max. Efficiency (%)	>95	
Euro Weighted Efficiency (%)	>94	
MPPT Efficiency (%)	99.5	

NOTE: Specifications included in this datasheet are subject to change without notice.

*Grid zero export option is available

GRID INTERACTIVE HYBRID		
Model No.	LFS103GIH	LFS105GIH
Battery		
Nominal Battery Voltage	24/48 V	48 V
Battery Types	Sealed/Flooded/Gel/Li-ion	
Charging Modes	4-Stage Charging Algorithm	
Maximum Charging Current	20 A	
General Data		
Dimensions (W/H/D)	634x350x164 mm BIU (458x203x150 mm)	
Weight (Kg)	25	28
Operating Temperature Range	up to +60°C	
Protection	Under Voltage, Over Voltage, Short Circuit, Overload	
Noise Emission	<35 dB	
Altitude (Above Sea Level)	3000 m	
Self-consumption at Night (W)	<15	
Topology	Transformerless	
Cooling Concept	Passive Cooling	
Environment Protection Rating	IP65	
Recommended Mounting	Wall Mounting	
Relative Humidity	0-95 %	
Display & Communication		
Display	128x64 Graphic LCD	
Display Parameters	PV - Voltage & Current, Battery - Voltage & Current, Grid Voltage, Grid Feed Current, Energy Generated, Energy Feed to Grid, Cumulative Energy Generated per Day	
Communication	RS-485	
Communication Interface (Optional)	WiFi 802.11 b/g/n	
Certifications		
Certifications	IEC 61683, IEC 60068-2(1,2,14,30), IEC 62116, IEC/EN 62109-1: 2010, IEC/EN 62109-2: 2011, IEC 61000, IEC62891, IS 16169, IS 16221-1,2, IEC-61727	

NOTE: Specifications included in this datasheet are subject to change without notice.

*Grid zero export option is available

LIVWIFI

PRODUCT DESCRIPTION

Livfast brings state of the art Livwifi device that will make GIH systems

IoT enabled and provide real-time solar data analytics for the concerned stakeholders.



LIVWIFI

Electrical Data

Power Requirements	5 V, 0.8 A
Max. Power Consumption	4W
Power Supply	External Adaptor (230 VAC, 1 Ph)

User Interface

WiFi (2.4 GHz, 802.11 b/g/n, WEP, WPA, WPA2, PSK)	Yes
RS 485	Yes
Analog Input for Connecting Weather Monitoring Station	Yes (Optional) - 4 Inputs
LED	4 Numbers - Power On, WiFi Connected, Internet Connected and In Slave Mode

Communication Range

RS 485	1000 m
--------	--------

Mechanical Data

Dimensions (W/H/D)	155x30x50 mm
Weight	250 g
Installation	Wall, Indoor

Environmental Conditions

Operation	up to +55°C
Relative Humidity (Non-Condensing)	95%
Protection Class	IP 20

General Data

Cloud Support	Yes
Language Support	EN

Features

No. of Connected Inverters	20
Storage	SD Card

3 PHASE GRID INTERACTIVE INVERTER

PRODUCT DESCRIPTION

Our range of 3 Phase Inverters is a state of the art technology with all the grid interactive features, including the flexibility for different large scale PV systems and applications

APPLICATION

Homes and establishments that need to reduce their electricity bills

8 YEAR
PRODUCT
WARRANTY



8-year warranty to ensure peace of mind and increased ROI



I-V curve scanning functionality to achieve enhanced safety, proactive maintenance, higher O&M efficiency and lower operation cost



Wide MPPT voltage range and with efficiency >99.9 % to yield greater solar energy



Highest rated PV input power to ensure maximized utilization of solar energy



Best in class real-time monitoring of solar systems installed, leading to superior customer service

SPECIFICATION

3 Phase Grid Interactive Series					
Parameters	LFS305GI	LFS308GI	LFS310GI	LFS320GI	LFS330GI
Input (DC)					
Max. Recommended PV Input Power	7320W	11710W	14630W	26600W	39900W
Start-up Input Voltage	180V			250V	
Number of MPPTs	2				
MPPT Voltage Range	160-960V			230-960V	
Input Range with Full Power Operation with 2 MPPTs Parallel	240-850V	380-850V	480-850V	480-850V	520-850V
Max. Input Current	11A/11A			24A/24A	30A/30A
Input Short-circuit Current for each MPPT	14A/14A			30A/30A	37.5A/37.5A
Output (AC)					
Nominal Output Power	5000W	8000W	10000W	20000W	30000W
Max. Output Power	5500VA	8800VA	11000VA	22000VA	33000VA
Max. Output Current	8A	12.8A	15.9A	32A	48A
Grid Input Voltage Range	310-480 VAC (Adjustable)				
Nominal Grid Frequency	50/60Hz				
THD/THDi	< 3 %				
Efficiency, Safety and Protection					
Max. Efficiency	98.0%	98.3%	98.3%	98.2%	98.4%
Euro Efficiency	97.5%	98.0%	98.0%	98.0%	98.2%
MPPT Adaptation Efficiency	> 99.5%			> 99.9%	
Self-consumption at Night	< 1 W				
Communication	RS 485, WiFi (Optional), GPRS (Optional)				
DC Switch	Yes				
DC Reverse Polarity Protection	Yes				
General Data					
Ambient Temperature	-25°C to +60°C				
Cooling	Natural				Fan
Dimension	457 x 452 x 202 mm			666 x 512 x 254 mm	
Weight	21Kg	22Kg	22Kg	37Kg	37Kg
Noise	< 29 dB			< 30 dB	< 45 dB
Ingress Protection	IP 65				
Warranty	8 Years				
Standards	IS 16221(Part-2), IS 16169, IEC 61727, IEC 60068, IEC 61683, IEC 62109, IEC 61000, IEC 62116				

NOTE: Specifications included in this datasheet are subject to change without notice.

ZERO EXPORT DEVICE

ABOUT PRODUCT

The device helps PV plants to function without net metering.

Also useful for establishments that have DG Sets wherein the solar power is not exported to the DG set.

SPECIFICATIONS	
Parameters	Values
Rated Supply Voltage	230 VAC
Power Consumption	< 3 W
Protection Class	IP30
Solar PV kW Compatibility	Up to 1.5 MW
Power Phase Connectivity	Single, Three
L1-N, L2-N, L3-N	90 - 270 Vrms
Input	0 - 1 A
Rated Frequency	50/60 Hz
Frequency Range	45 - 65 Hz
Response Time	1 s
Sampling Rate per Channel (x 10 Channels)	300 per Half Cycle
Switching Elements Max Current/ Voltage	2 A/250 VAC, 2 A/220 VDC
Power to Unit	Green LED
Grid Available	Green LED
Generation Available	Red LED
Operation Temperature	-25°C to 60°C
Dimensions (WxHxD)	200 x 180 x 55

NOTE: Specifications included in this datasheet are subject to change without notice.

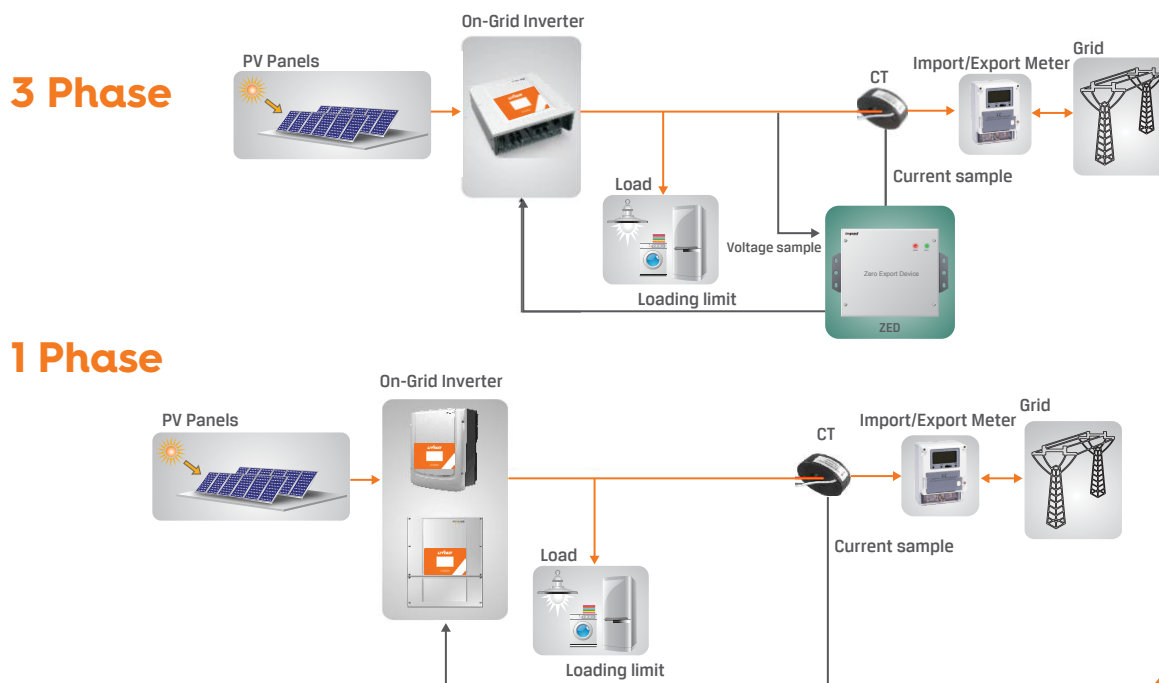



Note :

A large rectangular area with rounded corners, containing 20 horizontal dashed lines for writing. The area is framed by a light gray border.



LIVFAST SOLAR



18001025551

livserv@sar-group.com

www.livfast.in

Livfast Batteries Private Limited
Plot No.221, Udyog Vihar, Phase-1, Gurgaon-122016, Haryana, India.
www.livfast.in